

Wireless Sensor



Keep sensors, containing batteries, out of reach of children. Seek medical assistance immediately in case of ingestion.

Operating Conditions

Temperature: -40 to 85°C (40 to 185°F)

Humidity at 25°C: 0 to 100%RH

Construction

Ingress Protection: IP68

Material: ABS

Adhesive: 3M LSE-110WF

To receive data from the sensor it needs to be within range of a Cloud Connector with an active internet connection.

Sensor Installation



Ensure the mounting surface is clean. Peel off the adhesive backing and press it firmly into place for three seconds to ensure good adhesion.

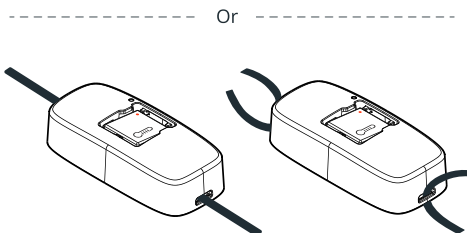

Use zip ties to attach the sensor in the desired location.



DISRUPTIVE
TECHNOLOGIES

For support and more information about our products, visit: d21s.com/support

Disruptive Technologies Research AS
Strandveien 17, 1366 Lysaker, Norway

TM and © Disruptive Technologies
Research AS. All rights reserved.

Country of origin: Norway

Safety & Use Manual

Please read this guide before attempting to operate the product

Failure to follow these instructions may result in an increased risk of personal injury or damage to property, including through fire, electrical shock, burns or suffocation.

Disruptive Technologies Research AS shall not be liable for damage caused where the product owner has failed to follow the instructions set out in this guide.

No changes shall be made to the equipment without the manufacturer's permission as this may void the user's authority to operate the equipment.

Sensor US & Industrial Sensor US

Model: 102250 & 102255

Frequency Band ISM 915 MHz

Transmit Power < 1 mW

FCC: This device complies with part 15 of the FCC Rules. Operation is subject to the following two conditions: (1) This device may not cause harmful interference, and (2) this device must accept any interference received, including interference that may cause undesired operation.

This device complies with the safety requirements for portable RF exposure in accordance with FCC rule part §2.1093 and KDB 447498 D01.

Symbols



Federal Communications Commission



Waste of Electrical and Electronic Equipment

Product Numbers

102951 - Wireless Temperature Sensor with Bracket (US)

102948 - Wireless Temperature Sensor with Data Backfill and Bracket (US)

ISED: This device contains licence-exempt transmitter(s)/ receiver(s) that comply with Innovation, Science and Economic Development Canada's licence-exempt RSS(s). Operation is subject to the following two conditions:
(1) This device may not cause interference
(2) This device must accept any interference, including interference that may cause undesired operation of the device

Cet appareil contient des émetteurs / récepteurs exemptés de licence conformes aux RSS (RSS) d'Innovation, Sciences et Développement économique Canada. Le fonctionnement est soumis aux deux conditions suivantes:

(1) Cet appareil ne doit pas causer d'interférences
(2) Cet appareil doit accepter toutes les interférences, y compris celles susceptibles de provoquer un fonctionnement indésirable de l'appareil

This device complies with the safety requirements for RF exposure in accordance with RSS-102 Issue 5 for portable use conditions.

Le présent appareil est conforme aux limites d'exposition aux RF conformément au norme CNR-102 émission 5 pour conditions d'utilisation portable.